

# Blender Buddy

- Robust blender extension for 2 flow meters
- Includes an analyzer port for accurate  $fiO_2$  readings
- Compatible with multiple blenders  
(must specify when ordering)
- Comes standard with a low flow and high flow flow meter (0-3.5 lpm and 0-15 lpm)

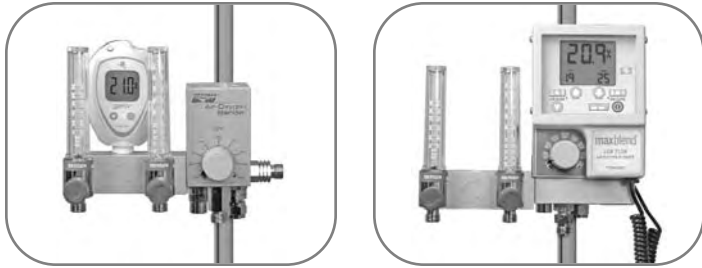

## Maxtec Introduces New Blender Buddy:

The all-new Blender Buddy turns any blender into the ultimate blending device. Its robust design provides the quality and reliability needed to ensure the ultimate patient care. This product securely attaches to any blender using a specific independent block (see part numbers below) to ensure that it doesn't swivel or move inadvertently. The oxygen port on the top of the manifold allows gas to be analyzed in a clean and dry environment away from the patient to avoid cross-contamination.

### Part Numbers: Manifold Block

Blender Buddy for Maxblend..... #HO-R219P11  
 Blender Buddy for Viasys (Bird) w/port..... #HO-R219P12-001  
 Blender Buddy for Sechrist Blender w/port... #HO-R219P13-001  
 Blender Buddy for Biomed Devices w/port.... #HO-R219P14-001

### Part Numbers: Available Flow Meters & DISS Fittings

0-15 lpm Flow Meter..... #HO-RP34P03-001  
 0-3.5 lpm Flow Meter..... #HO-RP34P03-002  
 0-200cc lpm Flow Meter..... #HO-RP34P03-003  
 0-1 lpm Flow Meter..... #HO-RP34P03-004  
 0-8 lpm Flow Meter..... #HO-RP34P03-005  
 0-70 lpm Flow Meter..... #HO-RP34P03-006  
 D.I.S.S. Fitting..... #HO-RP11P06

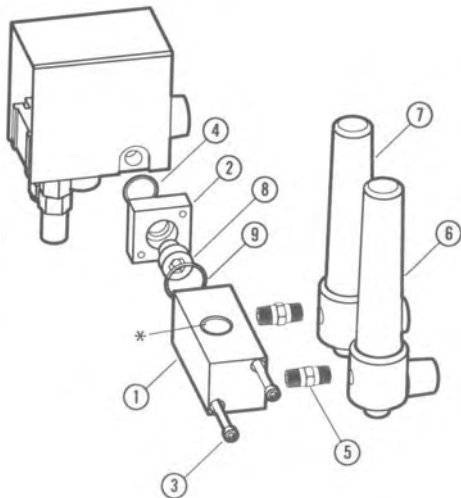

Application shown for Sechrist, Bird and Biomed Devices/Blenders  
 \*Accessory with sensor port shown

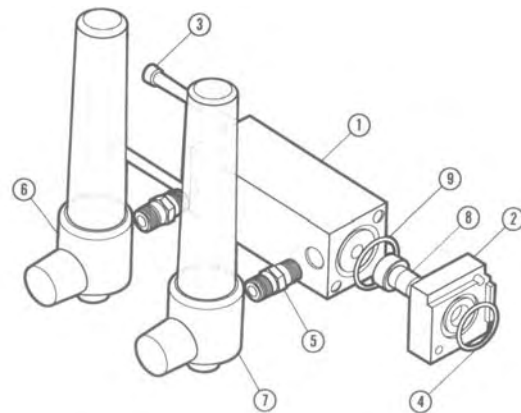

Application shown for Maxblend Blender

# Blenders

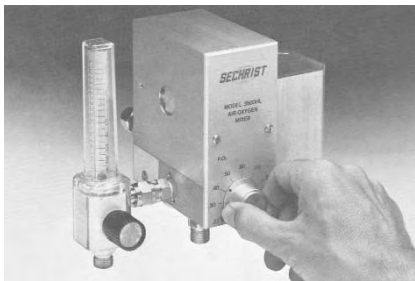

The Sechrist Model 3500HL Hi/Lo Flow Air-Oxygen Mixer is a precision pressure regulation and proportioning device which is designed to accurately mix Medical Breathing Air and Oxygen to any selected  $F_{I}O_2$  between .21 and 1.0 for delivery to a variety of respiratory care

equipment. Several important design considerations were incorporated for improved performance and service.

**SIMPLE** - It is well understood that if a device can be designed to perform its intended task in a straight-forward and simple manner, the better it will accomplish its function. A simple design will result in lower costs, better reliability and lower maintenance costs when compared with devices of similar function which are more complex in their design. The Sechrist 3500HL is significantly less complex than competitive units.

**ACCURATE** - The precision balance regulator design will allow the Sechrist 3500HL to maintain the selected delivery oxygen concentration within  $\pm 1$  percentage point of this value even if the supply gas pressures fluctuate over a wide range.

**VERSATILE** - The Sechrist 3500HL incorporates dual outlet connectors from which the full flow range is available. One of the outlet connectors is located on the side of the unit for the convenient connection of a flowmeter. The 3500HL is available in versions which provide for convenient pole mounting (1 to 1.5 inch diameter) or for wall mounting on a suction type bracket.

**FILTRATION** - The greatest enemy of gas mixing devices is contamination from the supply gases, especially the Medical Breathing Air supply. Proper filtration can remove contaminants before they enter the device. Therefore, we have incorporated an integral water trap/filter (0.1 micron) in the air inlet for the Sechrist 3500HL and also provided 7 micron sintered stainless steel (non-corroding) filters in both inlets of the unit.

Other features include a bypass/alarm system. If either supply gas should fail, this system will indicate the situation with an audible alarm and provide the remaining supply gas at the mixer outlets.

## Specifications

<b>Dimensions:</b>	H	6"	
	W	6"	Pole Mount
		6-1/2"	Wall Mount
	D	6"	Pole Mount
		5-1/2"	Wall Mount
<b>Weight:</b>	6 lbs		
<b>Accuracy*:</b>	$\pm 3\%$		
<b>Maximum Flow @ 60% dial setting and 50 psi supply pressures</b>	100 LPM		
<b>Bleed Flow:</b>	8 LPM		
<b><math>F_{I}O_2</math> Adjustable from:</b>	.21 + .01 to 1.0 - .01		
<b>Supply Pressure Range**:</b>	50 psi $\pm$ 10 psi		

\*Note: The mixer will maintain the delivered  $F_{I}O_2$  within  $\pm 1$  percentage point of the selected value with fluctuations of the supply pressures. The additional 2% error is caused by the readability of the set point and scale error.

\*\*Note: The outlet pressure of the mixer will always be slightly less than the lower of the two supply pressures. Some respiratory care equipment attached to the mixer may require a closer tolerance.



**#71-3500 CP-G**  
Standard Accessories  
1-10 LPM flowmeter  
1000 ml flowmeter

Accuracy\*:  $\pm 3\%$   
Maximum Flow: 40 LPM  
Bleed Flow: 2.5-4.5 LPM @ 8 LPM  
 $F_{I}O_2$  Range: .21 + 0.1 to 1.0 - 0.1  
Gas Supply Range: 50 psi  $\pm$  10 psi

Model #71-3500 CP-G is a low flow mixer specifically designed for ECMO or Heart-Lung Bypass applications.



**#71-20457-1**  
Standard Accessories:  
0-15 LPM flowmeter  
14 ft. air hose  
14 ft. oxygen hose  
water trap assembly

Accuracy\*:  $\pm 3\%$   
Maximum Flow: 40 LPM  
Bleed Flow: 2.5-4.5 LPM @ 8 LPM  
 $F_{I}O_2$  Range: .21 + 0.1 to 1.0 - 0.1  
Gas Supply Range: 50 psi  $\pm$  10 psi

Models #71-20457-1 and #71-20459-1 are low flow mixers designed for low flow general applications. #71-20457-1 utilizes a wall mount configuration and #71-20459-1 provides for pole mounting



**#71-20459-1**  
Standard Accessories:  
0-15 LPM flowmeter  
14 ft. air hose  
14 ft. oxygen hose  
water trap assembly



**#71-3600**

Accuracy\*:  $\pm 3\%$   
Maximum Flow: 100 LPM  
Bleed Flow: 8-10 LPM @ 16 LPM  
 $F_{I}O_2$  Range: .21 + 0.1 to 1.0 - 0.1  
Gas Supply Range: 50 psi  $\pm$  10 psi

Models #71-3600 and #71-3601 are high flow mixers designed for high flow general applications. #71-3601 utilizes a wall mount configuration and #71-3600 provides for pole mounting



**#71-3601**

## Ordering Information

**Part Number** **#71-3600**  
Model 3500HL for pole mounting

**Part Number** **#71-3601**  
Model 3500HL for wall mounting

## Optional Accessories

**Part Number** **#71-IV 308**  
Air Supply Hose 14'

**Part Number** **#71-IV 309**  
Oxygen Supply Hose 14'

# Blenders

## It's Modular ...

The unique modular design can cut routine maintenance time in half as well as reduce maintenance costs. The unit has easy to replace modular components and is easily maintained by any biomed department.

## It's User Friendly ...

A large selection control knob makes oxygen percentage adjustments easy. The infection control friendly housing is smooth and easy to clean.

## It's a High Performance Unit ...

The highly accurate unit maintains FiO<sub>2</sub>% even at low flows. It is economical and provides costs savings with less waste.



A unique, modular design air-oxygen blender

## It's Unique ...

It is the only unit available that allows the bleed control to be on or off providing quieter operation. This feature is especially useful in the NICU and PICU.

## It's Durable ...

The tough ABS housing makes the unit durable and the selection control knob is recessed preventing accidental damage.

## It's Versatile ...

The unit is available in two models, high and low flow. The Blender is easily mounted with a universal mounting bracket. It can be detached from the mounting bracket without removing hoses.

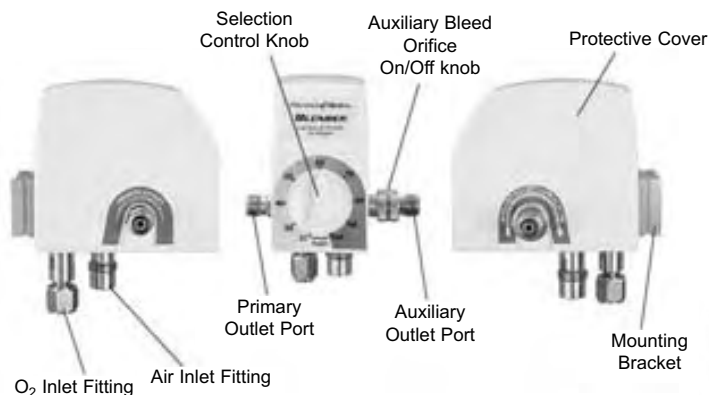

## Ordering Information

Part#	Description
#EC-PM5200	High Flow Blender
#EC-PM5200M	High Flow Blender w/3 movable ports
#EC-PM5300	Low Flow Blender
#EC-PM5300M	Low Flow Blender w/3 movable ports
#EC-504776	Wall Mount
#EC-504778	Pole Mount



## High Flow Blenders #EC-PM5200 / #EC-PM5200M

Specifications	#EC-PM5200	#EC-PM5200M
<b>Dimensions:</b> (w/o fittings)	Depth: 4.92" (12.5 cm) Width: 2.25" (5.7 cm) Height: 4.10" (10.4 cm)	Depth: 4.92" (12.5 cm) Width: 2.25" (5.7 cm) Height: 4.10" (10.4 cm)
<b>Weight:</b>	2.9lbs (1.3 kg)	3.4lbs (1.5 kg)
<b>Operating Temperature:</b>	59°F to 104°F (15°C to 40°C)	59°F to 104°F (15°C to 40°C)
<b>FiO<sub>2</sub> Accuracy:</b>	±3% of full scale	±3% of full scale
<b>Bypass Alarm Activation:</b>	13-25 psi (0.9-1.7 bar)	13-25 psi (0.9-1.7 bar)
<b>Primary Outlet Flow Range:</b>	15-120 LPM	15-120 LPM
<b>Auxiliary Outlet Flow Range:</b>	2-100 LPM	2-100 LPM
<b>Bleed Flow:</b> at 50 psi (3.4 bar)	13 LPM or less	13 LPM or less
<b>Maximum Combined Flow:</b> (all outlets)	>= 120 LPM	>= 120 LPM
<b>No. of Primary Outlet Ports:</b>	1	3
<b>No. of Auxiliary Outlet Ports:</b>	1	1

## Low Flow Blenders #EC-PM5300 / #EC-PM5300M

Specifications	#EC-PM5300	#EC-PM5300M
<b>Dimensions:</b> (w/o fittings)	Depth: 4.92" (12.5 cm) Width: 2.25" (5.7 cm) Height: 4.10" (10.4 cm)	Depth: 4.92" (12.5 cm) Width: 2.25" (5.7 cm) Height: 4.10" (10.4 cm)
<b>Weight:</b>	2.9lbs (1.3 kg)	3.4lbs (1.5 kg)
<b>Operating Temperature:</b>	59°F to 104°F (15°C to 40°C)	59°F to 104°F (15°C to 40°C)
<b>FiO<sub>2</sub> Accuracy:</b>	±3% of full scale	±3% of full scale
<b>Bypass Alarm Activation:</b>	18-22 psi (1.2-1.5 bar)	18-22 psi (1.2-1.5 bar)
<b>Primary Outlet Flow Range:</b>	3-30 LPM	3-30 LPM
<b>Auxiliary Outlet Flow Range:</b>	0-30 LPM	0-30 LPM
<b>Bleed Flow:</b> at 50 psi (3.4 bar)	3 LPM or less	3 LPM or less
<b>Maximum Combined Flow:</b> (all outlets)	>= 30 LPM	>= 30 LPM
<b>No. of Primary Outlet Ports:</b>	1	3
<b>No. of Auxiliary Outlet Ports:</b>	1	1

# Blenders



Specifications for: **#CK-2003FF**  
**Oxygen %** 21 - 100%  
**Number of Ports** 2  
**Left Flowmeter Range** 3 - 15 LPM with no bleed,  
 1 - 3 with bleed  
**Right Flowmeter Range** 0 - 3.5 LPM with 3 LPM bleed  
**Accuracy** ± 3% full scale  
**Size** 8.13 x 6.55 x 4.60 in.  
 20.65 x 16.64 x 11.68 cm.  
**Weight** 4.05 lbs. (1.84 kg.)

**#CK-2003FF1**  
 Neo<sub>2</sub> Blend with 15 LPM & 1.0 LPM flowmeters

**#CK-2003FF15**  
 Neo<sub>2</sub> Blend with 15 LPM & 15 LPM flowmeters

**#CK-2003FFA**  
 Neo<sub>2</sub> Blend with 15 LPM & 3.5 LPM flowmeters and bottom output

Bio-Med Devices is excited to announce the introduction of the latest addition to our line of precision Air/Oxygen blenders ... the uniquely designed, gas saving NEO<sub>2</sub> BLEND! Designed for the Neonatal Intensive Care Unit, it comes with two integral flowmeters. The flowmeter on the left side is for flows from 1 to 15 LPM. The right side flowmeter is 0 to 3.5 LPM. Unlike other blenders, the NEO<sub>2</sub> BLEND allows you to turn off the low flow gas bleed without disconnecting anything from the blender thus saving time, aggravation, gas and ultimately, money. This means the blender is always ready to use.

## Blender with Built-in Oxygen Analyzer



**Max Blend™**  
 24 Month warranty on analyzer/sensor  
 12 month warranty on blender

### Max Blend™

The Max Blend™ is the only oxygen/air blender with a built-in monitor. Maxtec® uses the leading technology in blending and combines it with state-of-the-art monitoring.

**Max Blend™ #HO-R203P05-001**  
 Low Flow Air Oxygen Blender  
 (Flow Range: 0 to 30 lpm output)

**Max Blend™ #HO-R204P05-001**  
 High Flow Air Oxygen Blender  
 (Flow Range: 2 to 100 lpm output)



**Max™-250ESF**  
 12 month warranty  
 Replacement Oxygen Sensor  
**#HO-R115P85**

**Max™-250E**  
 24 month warranty  
 Replacement Oxygen Sensor  
**#HO-R125P03-002**



# Blenders



#CK-2001

## Specifications

- Accuracy:  $\pm 3\%$  of Full Scale
- Supply Pressure: 30-75 psi
- O2 Percentage: 21-100%



#CK-2001K #CK-2002 #CK-2003 #CK-2004

## Blender Ports

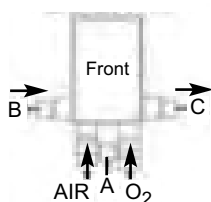

#CK-2001F



#CK-2002F70



#CK-2003FL



#CK-2003K

Model	Ports	Flow Range Port "A"	Flow Range Port "B"	Flow Range Port "C"	Size/Weight
#CK-2001	A,C	2-120 LPM (no bleed)	N/A	2-108 LPM 10-12 LPM bleed	3.5 x 3.4 x 3.6" (1.25 kg.) 2-3/4 lbs.
#CK-2001F**	A,C	2-120 LPM Output on bottom	N/A	15 LPM flowmeter On right	3.5 x 3.4 x 3.6" (1.25 kg.) 2-3/4 lbs.
#CK-2001K	A, Knob @ C	15-120 LPM (no bleed) 2-108 LPM (10-12 LPM bleed)	N/A	Knob Set > 15 Knob Set > 15	3.5 x 3.4 x 3.6" (1.25 kg.) 2-3/4 lbs.
#CK-2002	A	15-120 LPM (no bleed)	N/A	N/A	3.5 x 3.4 x 3.6" (1.25 kg.) 2-3/4 lbs.
#CK-2002F70**	D	15-120 LPM	0-70 Flowmeter On left	N/A	3.5 x 3.4 x 3.6" (1.25 kg.) 2-3/4 lbs.
#CK-2003	B,C	N/A	3-30 LPM (no bleed)	3-30 LPM (no bleed)	3.5 x 3.4 x 3.6" (1.25 kg.) 2-3/4 lbs.
#CK-2003FL**	A	0-30 LPM	0-30 LPM w/15 LPM flowmeter on left. Output on bottom Knob bleed switch on right	N/A	3.5 x 3.4 x 3.6" (1.25 kg.) 2-3/4 lbs.
#CK-2003K**	A,B	0-30 LPM	0-30 LPM Knob bleed switch on right	N/A	3.5 x 3.4 x 3.6" (1.25 kg.) 2-3/4 lbs.
#CK-2004	A,B,C	15-120 LPM (no bleed)	15-120 LPM (no bleed)	2-108 LPM (10-12 LPM bleed)	3.5 x 3.4 x 3.6" (1.25 kg.) 2-3/4 lbs.

\*\*Note: All Blenders can be ordered MRI-compatible by placing "M" after the number.

# Blenders/Accessories



#CK-2013BHR  
Blender bracket for horizontal rail for Biomed Devices blenders.



#CK-2013B

This bracket is designed to be used with Biomed Devices blenders on a 1" pole. It has stop pins in the slots to prevent the blender from sliding through.

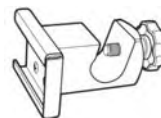

Pole Mount Bracket  
#HO-RP05P06  
For Viasys (Bird) and Maxtec Blenders

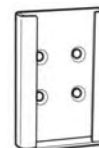

Wall Mount Bracket  
#HO-RP05P09  
For Viasys (Bird) and Maxtec Blenders



#CK-2013FR  
Blender brackets for Fairfield rail for Biomed Devices blenders.

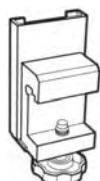

Pole Mount Bracket  
#HO-R100P09  
For Viasys (Bird) and Maxtec Blenders



#CK-2013BW  
This bracket is designed to be attached to a flat surface and to hold Biomed Devices blenders. It has stop pins in the slots to prevent the blender from sliding through.



#CK-2013BH  
Bracket for use with Biomed Devices blenders and heavy duty stands with 2" pole.

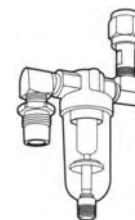

Water Trap  
#69-50001  
Air Inlet Filter/Water Trap



#CK-2013BSH  
Blender and support arm bracket for Biomed Devices blenders and heavy duty stands with 2" poles.



#CK-2013BVR  
Blender brackets for vertical rail for Biomed Devices blenders.

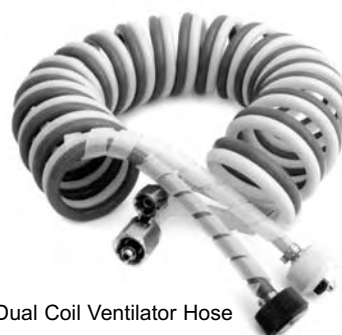

15' Dual Coil Ventilator Hose



15' Single Coil Oxygen Hose



15' Single Coil Air Hose



- #09-0060 15' Pressure Hose, Oxygen
- #09-0067 1-1/2' Pressure Hose, Oxygen
- #09-0938 9' Pressure Hose, Oxygen
- #09-1256 4' Pressure Hose, Oxygen
- #09-2899 15' Compressed Air Pressure Hose
- #09-03867 Hose, Air, High Press., 3' Female, both ends
- #09-03868 Hose, Oxygen, high Press., 3' Male/Female

## Coiled Hoses

Maxtec® offers the unique oxygen and air self-coiling hoses. They are made of a high-grade polyurethane material to help keep the work-space clean and tidy. Available in both single and dual coils with D.I.S.S. fittings only.

- 15' Dual Coil Ventilator Hose #HO-R129P02
- 15' Dual Coil Blender Hose #HO-R129P01
- 15' Single Coil Oxygen Hose #HO-R127P34
- 15' Single Coil Air Hose #HO-R128P34