

# Airway Superglottic (Disposable/Reusable)

## The New and Improved\* air-Q® Masked Laryngeal Airway

The new and improved design has evolved into a superior airway providing:

- New Infant Sizes
- Ease of Placement
- Better Seal in "Everyday" Use
- Improved Intubation Success

### Main Feature:

A patented design which incorporates a removable color-coded, tethered connector, providing for a smooth insertion of a standard ET tube while maintaining your everyday airway.

An intelligent choice developed by an anesthesiologist. Use it "everyday" to ventilate or intubate.

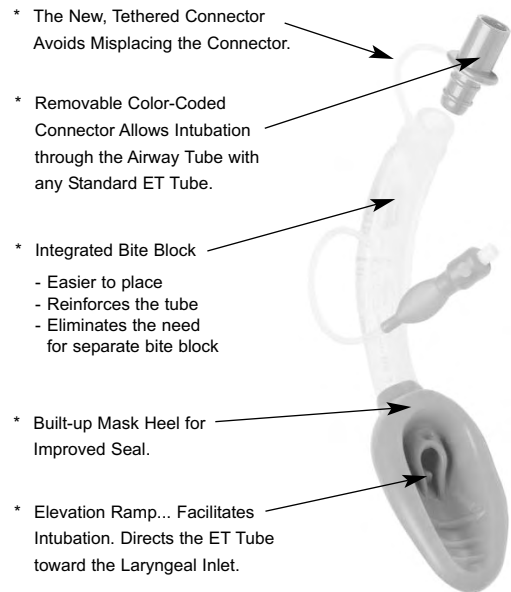

### Features

- \* Heel of mask cuff
- \* Elevation Ramp (built into airway outlet.)
- \* Tethered connector to tube
- \* Built-In Bite Block
- Auxiliary Hole
- Specially-designed ridges inside mask cavity
- Keyhole-Shaped Airway Outlet
- Removable connector for direct access to airway tube.
- Facilitates intubation, eliminates duplicate inventories and costly special ET tubes.

### Benefits

- Built-up for improved seal
- Facilitates placement, directs ET tube toward laryngeal inlet.
- To avoid misplacing the connector while in use.
  - Easier to place
  - Reinforces the tube
  - Eliminates the need for separate bite block
- Improves air flow and helps prevent epiglottic downfolding
- Provides lateral stability to help prevent tip from bending backward and improves mask seal
- Elevates epiglottis to provide unobstructed access to laryngeal inlet.
- Allows intubation through tube with any standard ET tube.
- Cost-effective.

## ORDERING INFORMATION

Part#	Size	Description	Quantity	Patient Weight.
#10-3010*	1.0	air-Q Disposable (blue connector)	10/Box	<7 kgs
#10-3015	1.5	air-Q Disposable (light green connector)	10/Box	7-17 kgs
#10-3020*	2.0	air-Q Disposable (orange connector)	10/Box	17-30 kgs
#10-3025	2.5	air-Q Disposable (yellow connector)	10/Box	30-50 kgs
#10-3035	3.5	air-Q Disposable (red connector)	10/Box	50-70 kgs
#10-3045	4.5	air-Q Disposable (green connector)	10/Box	70-100 kgs
#10-3016	1.5	air-Q Disposable w/lubricant & 10 cc syringe	10/Kit	7-17 kgs
#10-3026	2.5	air-Q Disposable w/lubricant & 10 cc syringe	10/Kit	30-50 kgs
#10-3036	3.5	air-Q Disposable w/lubricant & 10 cc syringe	10/Kit	50-70 kgs
#10-3046	4.5	air-Q Disposable w/lubricant & 10 cc syringe	10/Kit	70-100 kgs
#10-1006*	#00	Disposable Removal Stylet for 1.0 & 1.5 airway	10/Box	
#10-1005	#0	Disposable Removal Stylet for 2.0 & 2.5 airway	10/Box	
#10-1004	#1	Disposable Removal Stylet for 3.5 & 4.5 airway	10/Box	
#10-1007*	#00	Reusable Removal Stylet for 1.0 & 1.5 airway	1/Ea.	
#10-1003	#0	Reusable Removal Stylet for 2.0 & 2.5 airway	1/Ea.	
#10-1000	#1	Reusable Removal Stylet for 3.5 & 4.5 airway	1/Ea.	
#10-1020	2.0	air-Q Reusable	1/Box	17-30 kgs
#10-1025	2.5	air-Q Reusable	1/Box	30-50 kgs
#10-1035	3.5	air-Q Reusable	1/Box	50-70 kgs
#10-1045	4.5	air-Q Reusable	1/Box	70-100 kgs
#10-1011	2.0	Airway Connector (orange)	10/Pack	
#10-1012	2.5	Airway Connector (yellow)	10/Pack	
#10-1013	3.5	Airway Connector (red)	10/Pack	
#10-1014	4.5	Airway Connector (green)	10/Pack	
#10-2025	2.5	air-Q Reusable Cleaning Brush for 2.5	10/Pack	
#10-2035	3.5/4.5	air-Q Reusable Cleaning Brush for 3.5 & 4.5	10/Pack	

# Airway Superglottic

## Kendall Combitube



Esophageal/Tracheal Double Lumen Airway for Emergency or Difficult Intubation.

- Blind placement without laryngoscope
- Unique design provides patient airway with either esophageal or tracheal placement.
- Reduces risk of aspiration of gastric contents.
- Requires no restraining devices.
- Single patient use.
- Kit includes syringes and suction catheters.
- Packaged non-sterile.

## Combitube®

Esophageal/Tracheal Double-Lumen Airway

*Rapid intubation of difficult airways.*

When a difficult airway must be established, time and accuracy are critical. Now you can be assured of rapid intubation and effective ventilation with the **Combitube®** Esophageal/Tracheal Double-Lumen Airway from Nellcor. Unlike traditional endotracheal tubes, the **Combitube** airway is designed to establish a nonsurgical patient airway when placed into either the trachea or the esophagus.

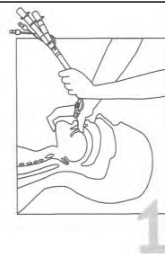

Insert the **Combitube** airway blindly into the mouth. Advance gently until the teeth or alveolar ridges are aligned between the two black rings.

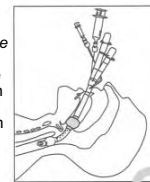

Inflate Line 1 through the blue pilot balloon leading to the large pharyngeal cuff with 100 mL of air for the 41 French or 85 mL of air for the 37 French, using the large syringe provided. Inflate Line 2 through the white pilot balloon leading to the smaller distal cuff with approximately 15 mL of air for the 41 French or 12 mL of air for the 37 French, using the small syringe provided.

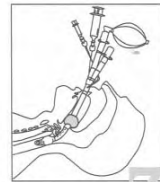

Since an esophageal placement of the **Combitube** airway is most likely, begin ventilation by attaching the ventilating device to the longer blue connecting tube marked No. 1. If auscultation of breath sounds is positive, indicating esophageal placement, continue ventilation. If esophageal placement is confirmed, the second clear connecting tube marked No. 2 can be used for gastric suction with the suction catheter provided.

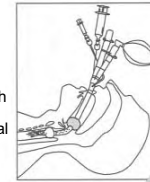

If auscultation of breath sounds is negative, a tracheal placement has been accomplished. The ventilation device should then be connected to the shorter clear connecting tube marked No. 2. The **Combitube** airway is then functioning as a normal tracheal tube.



- Unique double-lumen design allows for rapid airway establishment through either esophageal or tracheal placement.
- Blind placement eliminates the need for laryngoscope.
- Pharyngeal balloon holds device firmly in place and helps prevent the escape of gas through the nose or mouth.
- Full-length lumen allows for suctioning of gastric contents with no interruption of ventilation in the event the **Combitube** airway is placed in the esophagus.
- Esophageal cuff inflates to seal the esophagus so gas does not enter the stomach and gastric contents are not aspirated.
- Appropriate for prehospital, surgical and emergency use.

### Ordering Information

Description	Size I.D.	Item Number
<b>Combitube Standard Trays</b>		
For patients 4' to 5'6" tall	37 Fr	#AF-5-18537
For patients 5' tall and above	41 Fr	#AF-5-18541
<b>Combitube Singles</b>		
For patients 4' to 5'6" tall	37 Fr	#AF-5-18237
For patients 5' tall and above	41 Fr	#AF-5-18241
<b>Combitube Roll-ups</b>		
For patients 4' to 5'6" tall	37 Fr	#AF-5-18437
For patients 5' tall and above	41 Fr	#AF-5-18441
<b>Combitube Demonstration Airway</b>		
For demonstration use only	41 Fr	#AF-5-18141

## Rusch EasyTube® Double Lumen Tube

DESIGNED FOR DIFFICULT TRACHEAL OR ESOPHAGEAL INTUBATION

The Rusch EasyTube® is a dual lumen tube designed for difficult or emergency airway intubation and ventilation. The Rusch EasyTube creates a viable airway whether it is placed in the trachea or in the esophagus. When placed in the esophagus, the Rusch EasyTube allows the use of fiber-optic devices, or passage of a suction catheter or tube exchanger. The risk of tracheal trauma is reduced to a minimum due to the single lumen at the distal tip. The complete Rusch EasyTube® set includes tube, syringes pre-filled with air, and an extra length suction catheter. Packaged in a convenient roll-up kit.

- Single lumen at distal tip
- High-volume low-pressure PVC cuff at distal end
- Soft, latex-free cuff
- Allows for the use of fiber optic devices, suction catheters, or tube exchangers through second lumen
- Special placement rings
- Large volume syringe, pre-filled with air for the pharyngeal cuff
- Small volume syringe, pre-filled with air for the distal cuff



### Ordering Information

Item Code	Size	Version	Box Qty
#12-180041	41 Fr	Large	4
#12-180028	28Fr	Small	4

# Airway Visualization

*air-Vu®/air-Vu Plus™  
fiber optic scopes  
for visualizing ET tube  
placement during intubations.*



Light Source Options



air-Q® Masked Laryngeal Airway

An important addition to the *air-Q®* product line.

The new *air-Vu®* mimics the hyper-curved *air-Q* for ease of insertion.

This rigid scope incorporates fiber optic technology into every intubation allowing for direct visualization of the airway through enhanced optics providing ease of insertion.

With the use of advanced fiber optics, you are able to visually verify proper placement of the endotracheal tube as it passes between the vocal cords.

The new design and superior features of the *air-Vu* make it the "clear" instrument of choice when faced with a difficult intubation.

*air-Q® and air-Vu®  
partners in airway management*

## **air-Vu™ Rigid Fiber Optic Laryngoscope**

#EK-30000GLMM	air-Vu Rigid Fiber Optic Scope	1/ea.
#EK-30000GLMMPLUS	air-Vu Plus Rigid Fiber Optic Scope	1/ea.
#EK-30200	Replacement Tube Stop, Adult	1/ea.
#EK-30410	Oxygen Port Connector	1/ea.
#EK-5197200	Ultra LED Light Source	1/ea.
#53-5-0236-08	Greenline® Mini Penlite Handle (chrome plated brass)	1/ea.
#53-5-0236-10	Greenline® Penlite Handle	1/ea.

# Airway Guard

**Airway Guard** is a bite blocker that is inserted on either side of the breathing tube. The **Airway Guard** fits between the upper and lower teeth on the sides of the mouth and maintains a 15 mm gap between the upper and lower jaws. This gap prevents the teeth from clenching together and occluding the passage of air through the tube.

**Airway Guard** is made of Polypropylene, an FDA approved plastic material. It is latex free and is for single use only. It consists of a body and a flange that is attached to the outer surface of the body. The body of the **Airway Guard** is placed between the upper and lower teeth. It is contoured to fit the dental arch. The flange remains at the lips to prevent the device from sliding inside the mouth. The **Airway Guard** is designed to attach to the breathing tube for added stability and airway protection.

## How to Insert Airway Guard:

After proper placement of the endotracheal tube or laryngeal mask airway (LMA), separate the upper and lower jaws and place **Airway Guard** on either side of the breathing tube. If placed correctly, the tapered end should lay between the upper and lower molars and the flange should rest outside the lips to prevent the **Airway Guard** from sliding inside the mouth. Before securing the device, make sure the lips are clear and not pushed against the teeth or flange.

After **Airway Guard** is positioned correctly, engage the breathing tube inside the notch provided on the flange. To avoid accidental extubation you may tape the tube and the **Airway Guard** to the patient's face for added stability.

This device should be handled only by professionals trained in airway management.

## Bronchoscopy and Gastroscopy:

To avoid bite damage to Bronchoscope or Gastroscope, place Airway Guard on the side of the mouth in the usual manner and secure with a tape across the face. Introduce the scope through the appropriately sized notch.

## Sizes:

The **Airway Guard** is available in multiple sizes to fit either an LMA or endotracheal tube. The LMA sizes are marked 3, 4 and 5. The ET tube sizes are marked ET7, ET8 and ET9. Since the ET tube sizes are very close; one size of Airway Guard may fit more than one size ET tube.

Airway Guard is manufactured in a clean environment, individually encased in plastic bags, labeled and packaged. It is considered clean but not sterile.

## Cautions:

We recommend that this device not be used for patients with unhealthy teeth, multiple loose or multiple missing teeth. It should be used with care in patients with dental prosthesis.

### Size (3) - Item #FV-LMA-3

It has the small body, notch diameter 15mm, notch opening 13mm.

### Size (4) - Item #FV-LMA-4

It has the large body, notch diameter 15mm, notch opening 13mm.

### Size (5) - Item #FV-LMA-5

It has the large body, notch diameter 17mm, notch opening 15mm.

*The above sizes fit the corresponding (LMA) size.*

*All Packaged 100/Box*

### Size (7) - Item #FV-ET-7

It has the small body, notch size 9mm, notch opening 7.5mm.

### Size (8) - Item #FV-ET-8

It has the large body, notch size 10mm, notch opening 8.5mm.

### Size (9) - Item #FV-ET-9

It has the large body, notch size 11mm, notch opening 9.5mm.

*The above 3 sizes are for (ET) tubes. Since the difference in the (ET) tube sizes is very small, each Airway Guard size can fit same size tube, one size above and one size below. For example, Airway Guard size (8) can fit size 8, 7.5 and 8.5 (ET) tubes.*



## MERCURY® COLOR-CODED ORAL AIRWAYS

International color-coding provides instant identification of size. The soft, kink-resistant Guedel Airways are also engraved with the millimeter size on the flange.



Std Pack 10/Pkg	Size	Color-Coded Guedel Airways
#10-81250C	0/50mm	Blue - Infant
#10-81260C	1/60mm	Black - Child
#10-81270C	2/70mm	White - Sm Adult
#10-81280C	3/80mm	Green - Med Adult
#10-81290C	4/90mm	Yellow - Lg Adult
#10-81210C	5/100mm	Red - X-Lg Adult

### Berman Airways



Std Pack 10/Pkg	Size	Color-Coded Berman Airways
#10-80040C	00/40mm	Pink
#10-80050C	0/50mm	Blue
#10-80060C	1/60mm	Black
#10-80070C	2/70mm	White
#10-80080C	3/80mm	Green
#10-80090C	4/90mm	Yellow
#10-80000C	5/100mm	Red
#10-80010C	6/110mm	Orange

# Airways

## Disposable Berman, Guedel

All Mercury® Oral Airways are marked with the size on the bite block for ease of identification. The airways feature kink-resistant construction and smoothly rounded edges for patient comfort.



Std Pack 10/Pkg	Size	Berman Airways
#10-80040	00	40mm
#10-80050	0	50mm
#10-80060	1	60mm
#10-80070	2	70mm
#10-80080	3	80mm
#10-80090	4	90mm
#10-80000	5	100mm
#10-80010	6	110mm

The Guedel design oropharyngeal airway provides the desired large flange, reinforced bite area and gentle curve that has made this design one of the most popular. By nature of its design, the Guedel airway provides a large tubular lumen for increased air exchange and insertion of suction apparatus.



Std Pack 10/Pkg	Size	Guedel Airways
#10-81250	0	50mm
#10-81260	1	60mm
#10-81270	2	70mm
#10-81280	3	80mm
#10-81290	4	90mm
#10-81210	5	100mm

**Mercury Medical® Oral Airways are manufactured with polyethylene plastic which does not contain latex protein.**

## Color Coded Berman

**New** - Color Coded Berman Airways. A simple idea makes size identification easier for you. Premium upgrade without a premium price. Color Coded Berman airways are latex-free.

### Oral Airway



*Latex-Free*

#### Specifications:

- ✧ Color coded
- ✧ mm length printed on airway
- ✧ Single use
- ✧ Latex-free
- ✧ Non-sterile

#### Benefits:

- ✧ Easy to identify
- ✧ Full range of sizes
- ✧ Convenient packaging

#### Color Coded Berman Airways - Bags

Product #	Size	Length	ISO Standard Size Design	Color Code	Bag Qty
12-121801	00	40mm	4	Pink	50
12-121850	0	50mm	5	Lt. Blue	50
12-121802	1	60mm	6	Black	50
12-121870	2	70mm	7	White	50
12-121803	3	80mm	8	Green	50
12-122804	4	90mm	9	Yellow	50
12-121805	5	100mm	10	Lavender	50
12-121806	6	110mm	11	Orange	50

#### Color Coded Berman Airways - Individually Packaged

Product #	Size	Length	ISO Standard Size Design	Color Code	Box Qty
12-122001	00	40mm	4	Pink	10
12-122050	0	50mm	5	Lt. Blue	10
12-122002	1	60mm	6	Black	10
12-122070	2	70mm	7	White	10
12-122003	3	80mm	8	Green	10
12-122004	4	90mm	9	Yellow	10
12-122005	5	100mm	10	Lavender	10
12-122006	6	110mm	11	Orange	10

#### Color Coded Berman Airways - Individually Packaged

Product #	Size	Length	ISO Standard Size Design	Color Code	Box Qty
12-121901	00	40mm	4	Pink	50
12-121950	0	50mm	5	Lt. Blue	50
12-121902	1	60mm	6	Black	50
12-121970	2	70mm	7	White	50
12-121903	3	80mm	8	Green	50
12-121904	4	90mm	9	Yellow	50
12-121905	5	100mm	10	Lavender	50
12-121906	6	110mm	11	Orange	50

#### Color Coded Berman Airways - Emergency Pack

Product #	Sizes	Box Qty
12-396274	One of each size	1

# Airways

## Airways - Oropharyngeal Rusch

### Guedel Airways

• Packed 10/Box

<u>Clear</u>	<u>Size</u>	<u>Black Rubber</u>
#12-124700-000	30.0mm	#12-124500-000
#12-124700-00	40.0mm	#12-124500-00
#12-124700-0	50.0mm	#12-124500-0
#12-124700-1	60.0mm	#12-124500-1
#12-124700-2	70.0mm	#12-124500-2
#12-124700-3	80.0mm	#12-124500-3
#12-124700-4	90.0mm	#12-124500-4
#12-124700-5	100.0mm	#12-124500-5
#12-124700-6	120.0mm	#12-124500-6

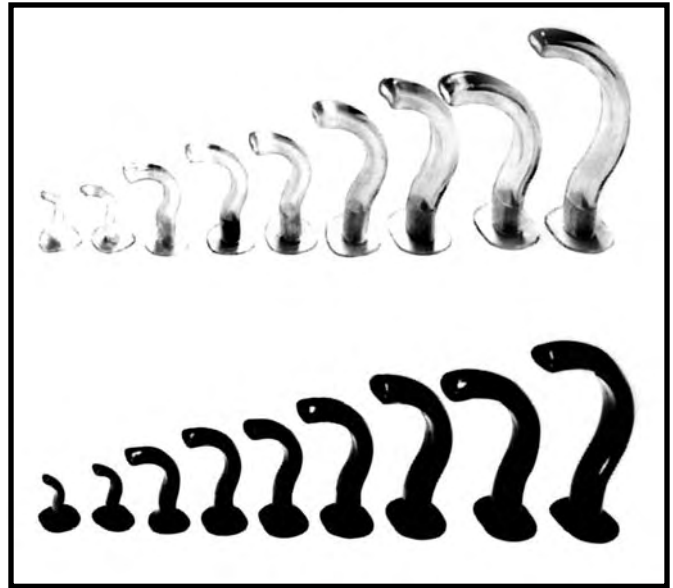

## SPECIALTY AIRWAYS

### Williams Airway Intubator (The Round Hole Airway)

The airway intubator is cylindrical on the proximal half and open on the distal half of the lingual surface. Uses include a means of intubating the trachea, an oropharyngeal airway or a guide for fiber optic laryngoscope placement.



### Packaged 10/Pkg

#19-00485 9 cm for adult females. Recommended for use with up to 7.5 mm I.D endotracheal tubes.

#19-00486 10 cm for adult males. Recommended for use with up to 8.5 mm I.D endotracheal tubes.



### Epistaxis Airway Dr. H. Masing pattern, Inflatable Nasal Tube

Controls severe hemorrhage in the nasal cavity and bilateral stabilization of the bony cartilaginous structure after fracture of the nose. Designed for gentle hemostasis of the nose and nasopharynx. The anatomically contoured cuff is made of silicone-latex. The presence of silicone results in minimal adherence to the mucous membranes and a traumatic removal.

#12-209302-1	3 ml	Size 1 - 2/Box
#12-209302-2	6 ml	Size 2 - 2/Box
#12-209302-3	9 ml	Size 3 - 2/Box



### Patil Intubation Oral Airway

Patil-Syracuse Oral Airway	Size 2	#19-00-492
Patil-Syracuse Oral Airway	Size 4	#19-00-494

Used in conjunction with the Patil-Syracuse mask, permits endoscopy in anesthetized patients with minimal interference with ventilation.



# Airways/Nasopharyngeal

## Original Style "Blue" Robertazzi Nasopharyngeal Airways

### "BLUE" LATEX ROBERTAZZI

#### Features

- Nine sizes available: 30-36FR
- Sterile
- Best Quality
- Smooth surface for easy insertion
- Accurate sizing of airway
- Soft - to reduce trauma to nasal passage
- Flexible
- Resists collapse or kinking
- Resilient
- Process to reduce latex protein

#### Nasopharyngeal Airways

Sun●Med Healthcare is pleased to announce our original "Blue" latex nasopharyngeal tubes have been improved through a unique manufacturing process. All nine sizes are treated to provide an extremely smooth surface to accommodate the patient's comfort and easing of insertion and removal.

To reduce undesirable proteins, a proprietary three-step procedure is employed prior to sterilizing this product, removing antigenic protein inherent to all natural latex.

#### TEST I: ASTM D 5712 TOTAL PROTEIN (LOWRY)

A total protein Lowry Assay test has been obtained on our nasopharyngeal tubes indicating less than 50ug/g total protein.

#### TEST II: ASTM D 64499-00 ANTIGENIC PROTEIN

The newer, more specific Elisa test to determine the antigenic protein level has determined our nasopharyngeal tubes have less than 0.6ug/g antigenic protein. The above analyses were carried out by Guthrie Research Institute and certified to Sun●Med Healthcare by Akron Rubber Laboratory Inc., both the Lowry Assay and the Elisa test results are available upon request.

## Latex Free Nasopharyngeal Airways

### ROBERTAZZI STYLE

Latex free nasopharyngeal airways have the same characteristics as the popular "Blue Latex" airway, in softness and flexibility.

- Latex free
- Soft - no damage to nasal passage
- Flexible
- Resists collapse or kinking
- Resilient
- Nine sizes available: 20-36FR
- Sterile & disposable



### ADJUSTABLE AIRWAY

- Soft moveable flange
- 13 sizes 12-36FR
- Latex free
- Sterile & disposable



Item #	Size	Description	Box
#53-1-5076-20	20FR	"Blue" Robertazzi - Sterile	10
#53-1-5076-22	22FR	"Blue" Robertazzi - Sterile	10
#53-1-5076-24	24FR	"Blue" Robertazzi - Sterile	10
#53-1-5076-26	26FR	"Blue" Robertazzi - Sterile	10
#53-1-5076-28	28FR	"Blue" Robertazzi - Sterile	10
#53-1-5076-30	30FR	"Blue" Robertazzi - Sterile	10
#53-1-5076-32	32FR	"Blue" Robertazzi - Sterile	10
#53-1-5076-34	34FR	"Blue" Robertazzi - Sterile	10
#53-1-5076-36	36FR	"Blue" Robertazzi - Sterile	10

Sterile - "Blue" Robertazzi Nasopharyngeal Kits		
#53-1-5076-04	Sizes 20, 24, 28, 32FR w/sterile lubricating jelly	4/pack
#53-1-5076-06	Sizes 22, 24, 26, 28, 30, 32FR w/sterile lubricating jelly	6/pack
#53-1-5076-09	Sizes 20, 22, 24, 26, 28, 30, 32, 34, 36FR w/sterile lubricating jelly	9/pack

Item #	Size	Description	Box
#53-1-5075-20	20FR	Robertazzi Style Airway	10
#53-1-5075-22	22FR	Robertazzi Style Airway	10
#53-1-5075-24	24FR	Robertazzi Style Airway	10
#53-1-5075-26	26FR	Robertazzi Style Airway	10
#53-1-5075-28	28FR	Robertazzi Style Airway	10
#53-1-5075-30	30FR	Robertazzi Style Airway	10
#53-1-5075-32	32FR	Robertazzi Style Airway	10
#53-1-5075-34	34FR	Robertazzi Style Airway	10
#53-1-5075-36	36FR	Robertazzi Style Airway	10

Sterile/Disposable/Latex Free Nasopharyngeal Kits		
#53-1-5075-04	Sizes 20, 24, 28, 32FR w/sterile lubricating jelly	4/pack
#53-1-5075-06	Sizes 22, 24, 26, 28, 30, 32FR w/sterile lubricating jelly	6/pack
#53-1-5075-09	Sizes 20, 22, 24, 26, 28, 30, 32, 34, 36FR w/sterile lubricating jelly	9/pack

Item #	Size	Description	Box
#53-1-5072-12	12FR	Adjustable Flange Airway	10
#53-1-5072-14	14FR	Adjustable Flange Airway	10
#53-1-5072-16	16FR	Adjustable Flange Airway	10
#53-1-5072-18	18FR	Adjustable Flange Airway	10
#53-1-5072-20	20FR	Adjustable Flange Airway	10
#53-1-5072-22	22FR	Adjustable Flange Airway	10
#53-1-5072-24	24FR	Adjustable Flange Airway	10
#53-1-5072-26	26FR	Adjustable Flange Airway	10
#53-1-5072-28	28FR	Adjustable Flange Airway	10
#53-1-5072-30	30FR	Adjustable Flange Airway	10
#53-1-5072-32	32FR	Adjustable Flange Airway	10
#53-1-5072-34	34FR	Adjustable Flange Airway	10
#53-1-5072-36	36FR	Adjustable Flange Airway	10

# Airways/Nasopharyngeal

## Airways - Nasopharyngeal with Adjustable Flange

Allows for accurate positioning to prevent the gag reflex. The flange can be manipulated along the shaft to allow positioning of the airway for length accordingly.



<u>Item</u>	<u>Description</u>	<u>Item Number</u>	<u>Size/O.D</u>	<u>Box Qty.</u>
Nasopharyngeal Airway Sterile	<ul style="list-style-type: none"> <li>• Silkotex®</li> <li>• Adjustable</li> <li>• Single Use</li> </ul>	#12-185200-20	20F	10
		#12-185200-22	22F	10
		#12-185200-24	24F	10
		#12-185200-26	26F	10
		#12-185200-28	28F	10
		#12-185200-30	30F	10
		#12-185200-32	32F	10
		#12-185200-34	34F	10
		#12-185200-36	36F	10



<u>Item</u>	<u>Description</u>	<u>Item Number</u>	<u>Size/O.D</u>	<u>Box Qty.</u>
Nasopharyngeal Airway Non- Sterile	<ul style="list-style-type: none"> <li>• Soft Red Rubber</li> <li>• Adjustable Flange</li> <li>• Pediatric Sizes</li> </ul>	#12-125200-12	12F	5
		#12-125200-14	14F	5
		#12-125200-16	16F	5
		#12-125200-18	18F	5
		#12-125200-20	20F	5
		#12-125200-24	24F	5
		#12-125200-26	26F	5
		#12-125200-28	28F	5
		#12-125200-30	30F	5
		#12-125200-32	32F	5
		#12-125200-34	34F	5
				#12-125200-36

## Oberto Mouth Prop Non-Sterile

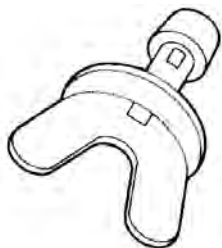

### Item Number

#12-5675-00

- Latex with central air vent

A specialized product for use in electro-convulsive therapy and epileptic spasm.

# Airways/Nasopharyngeal

<u>Item</u>	<u>Description</u>	<u>Item Number</u>	<u>Size/O.D</u>	<u>Box Qty.</u>
<b>Robertazzi Nasopharyngeal Airways</b>  	• Soft amber latex	<b>#12-1230-20</b>	20F	10
	• Available in	<b>#12-1230-22</b>	22F	10
	even sizes 20-36F	<b>#12-1230-24</b>	24F	10
		<b>#12-1230-26</b>	26F	10
		<b>#12-1230-28</b>	28F	10
		<b>#12-1230-30</b>	30F	10
		<b>#12-1230-32</b>	32F	10
		<b>#12-1230-34</b>	34F	10
		<b>#12-1230-36</b>	36F	10

The ideal nasal airway to maximize patient comfort.

<u>Item</u>	<u>Description</u>	<u>Item Number</u>	<u>Size/O.D</u>	<u>Box Qty.</u>
<b>Ultra Robertazzi Nasopharyngeal Airways Sterile</b>  	• Soft, flexible Ultrasil material	<b>#12-1231-20</b>	20F	10
		<b>#12-1231-22</b>	22F	10
	• Silicone Coated latex	<b>#12-1231-24</b>	24F	10
		<b>#12-1231-26</b>	26F	10
	• Available in even sizes 20-36F	<b>#12-1231-28</b>	28F	10
		<b>#12-1231-30</b>	30F	10
	• Single Use	<b>#12-1231-32</b>	32F	10
		<b>#12-1231-34</b>	34F	10
		<b>#12-1231-36</b>	36F	10

A disposable soft, flexible nasal airway maximizing patient comfort.

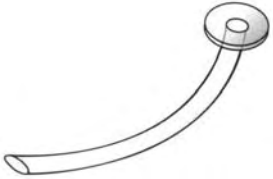
<u>Item</u>	<u>Description</u>	<u>I.D./MM</u>	<u>Item Number</u>	<u>Size/O.D</u>	<u>Box Qty.</u>
<b>Nasopharyngeal Airway Sterile</b>  	• Soft PVC	2.5	12-1233-12	12F	10
	• Available in sizes 12 - 36F	3.0	12-1233-14	14F	10
	• Interior striations for smooth suction catheter insertion	3.5	12-1233-16	16F	10
	• Bevel tip	4.0	12-1233-18	18F	10
	• Single Use	4.5	12-1233-19	19F	10
		5.0	12-1233-20	20F	10
		5.5	12-1233-22	22F	10
		6.0	12-1233-24	24F	10
		6.5	12-1233-26	26F	10
		7.0	12-1233-28	28F	10
		7.5	12-1233-30	30F	10
		8.0	12-1233-32	32F	10
		8.5	12-1233-34	34F	10
		9.0	12-1233-36	36F	10

LATEX-FREE



<u>Cat. No.</u>	<u>I.D.</u>	<u>O.D.</u>	<u>Qty.</u>
#04-340060	6.0mm	8.0mm	10/Box
#04-340070	7.0mm	9.5mm	10/Box
#04-340080	8.0mm	10.5mm	10/Box
#04-340090	9.0mm	12.0mm	10/Box

Nasopharyngeal Airways are made of a soft, compliant PVC which conforms readily to nasopharyngeal anatomy. Maximum kink-resistance helps assure a patent airway and the satin-smooth finish facilitates insertion. The smoothly rounded edges provide increased patient comfort and safety. The nasopharyngeal airways are supplied sterile in an easy-to-open blister basin package.